

WILLIAMS BATTERS



MELBOURNE, VIC 60/485 St Kilda Road

1 BED **1** BATH **1** CAR

Outstanding top floor north facing Art Deco style apartment in the iconic “Sheridan Close”, which is situated on Melbourne's most sought after boulevards. You will receive income from day one as the owner will enter a lease on settlement at a rental of \$19,960 p.a paid monthly.

This unit is accessed via lift and as you can see from the photo's it is generous in its size. It was renovated some years ago and comprises a spacious lounge/dining room with large windows capturing plenty of light. A big main bedroom, well fitted kitchen and tiled bathroom. In addition there is an undercover car space and storage unit.

\$499,000

Contact: Joshua Ling
(03) 9866 4411
0448 448 982
Bill Cook
(03) 9866 4411
0411 089 890

Type: Apartment

Sold Date: 21/05/2016

<https://www.williamsbatters.com.au>

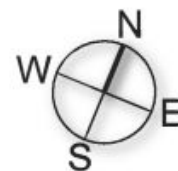
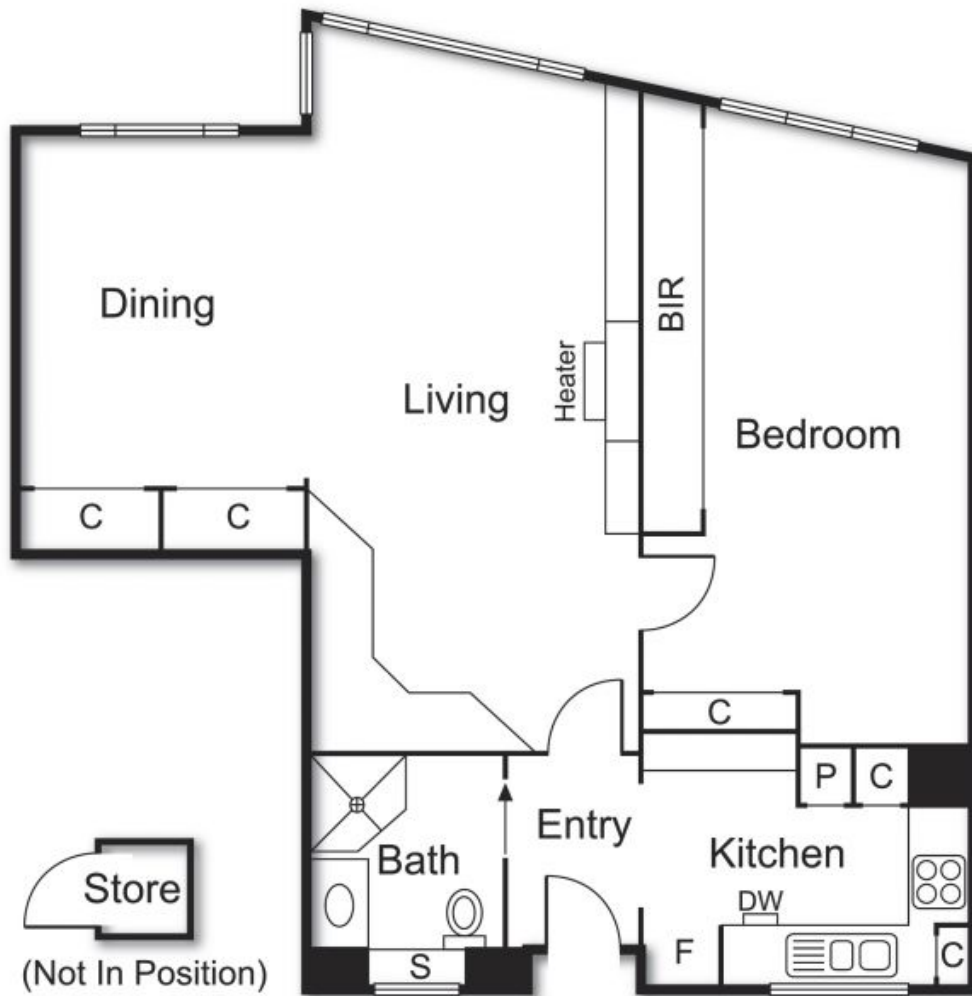

Plans shown are only indicative of layout. Dimensions are approximate.

MELBOURNE, VIC
60/485 St Kilda Road